

A WORKPLACE TO IMPROVE YOUR PROFIT

Serviced and Managed Office Space for 1-200 People



WHERE BUSINESS LIVES



IMPROVE BUSINESS AGILITY

THE ULTIMATE IN WORKPLACE PERFORMANCE

At the heart of our offer is the ability to align your property to your growth and the ups and downs of your business. The wrong property choice affects not only your business agility, but competitiveness and subsequent profits. At Stonemartin we provide a range of flexible cost effective working solutions:

- Fully serviced, furnished & equipped offices for companies seeking immediate solutions on highly flexible lease arrangements
- Space² virtual office product offering a combined range of benefits and workplace solutions - all the benefits of a Grade 'A' City Centre building without taking a physical office
- Meeting, conferencing and training facilities delivered with hotel levels of service
- Managed offices offering bespoke options for up to 200 workstations on flexible lease terms for up to five years and beyond

OFFICES :

- Stunning workstation furniture and fully I.T. enabled
- Beautifully designed unbranded interiors
- Grade 'A' City Centre buildings
- Surrounded by retail and public transport amenities

CONFERRING :

- Meeting, conferencing and training rooms for up to 100 delegates
- All inclusive price policy - day delegate rate from £55 per person
- 24 hour delegate rate in selected buildings
- Leading edge AV facilities with video conferencing

DIRECTORS' ROOM :

- Exclusive UK network for IoD members
- Hold informal meetings with complimentary beverages
- IoD membership packages for qualifying resident clients
- Integrated within all our buildings



A TRUE BUSINESS ENVIRONMENT AND WORKPLACE WITH HOTEL STANDARDS

SERVICE

Service within Stonemartin buildings is a living, breathing part of what we offer. We are here to ensure that you are our first priority when it comes to understanding exactly what your business requires and when it needs it. Whether it is a warm welcome for visitors at reception or I.T. / business support, we are here to attend to your day to day needs.



CONCIERGE

When you check into a quality hotel, you expect first class service, refined comfort and attentive consideration. This is exactly how we seek to run our buildings for you and your guests. Like the concierge of any good hotel, the Stonemartin concierge will have good local knowledge and a can-do attitude to requests from you and your visitors. If there is anything we can do to create the perfect environment, we will.

Concierge Services are currently being rolled out across the UK. All of our buildings have attentive front of house staff.



SPACE² VIRTUAL SOLUTIONS :

- Telephone, mail, meeting and hot desk facilities
- Simple selection of services to suit your requirement
- Prime City Centre presence from £50 per month
- Providing businesses with the Space² grow throughout the UK





OUR SERVICED OFFICE SOLUTIONS INCLUDE

- An environment that allows your business to grow in line with your plan in a cost effective manner
- The ability to focus your time on running your business not your property
- The benefit of being part of a buzzing business environment
- Transfer of risk allowing greater visibility of associated costs
- Superior buildings in prime City Centre locations

◦ BUILDINGS

- All buildings offer prestigious addresses in central business districts **INC**
- Fully furnished and well equipped **INC**
- Office sizes from one person to multifunctional open plan offices **INC**
- Our scale of buildings (typically 100,000 sqft) allows businesses to grow from a fully serviced office to a bespoke managed solution **INC**
- IoD hub **INC**
- IoD Directors' Room **OPT**
- DDA / Health and Safety compliant **INC**
- Concierge / 24hr security **INC**
- CCTV **INC**

◦ WORKSTATION/OFFICE

- Furniture comprises of desk, chair, pedestal and storage **INC**
- Phone / Call handling / Messaging **INC**
- Client signage in reception **INC**
- Cable infrastructure **INC**
- Cleaned daily **INC**

◦ CONNECTIVITY

- Install your own connectivity using our pre-installed cable infrastructure or choose from our fully scaleable range of options
- High speed internet access **OPT**
- Local area network **OPT**
- Secure firewalls **OPT**
- Secure and environmentally controlled comms rooms **OPT**
- On-site I.T. support / help desk **OPT**

◦ IoD hub MEETING / CONFERRING / TRAINING VENUES

- Fully equipped meeting rooms 1-100+ delegates* available for hire by the hour, half day or day with 50% discounts to rate card for same day bookings
- Range of fully equipped rooms **INC**
- Access to video conferencing **OPT**
- Free coffee / tea / water / biscuits **INC**
- Free broadband / local and national telephone calls **INC**
- I.T. support **INC**
- Support personnel for business services **OPT**

* Maximum delegates of 100 not available in all of our buildings. Certain buildings have event venues for up to 200 people.

◦ COMMON AREAS

- Contemporary receptions **INC**
- Attentive service for you and your guests **INC**
- Kitchens outside your demise **INC**
- Business support - Secretarial support / Office supplies **OPT**
- Reprographic areas including colour and black and white copiers - price applied per copy **OPT**
- IoD hub / Directors' Room **OPT**

INC = Inclusive Item **OPT** = Optional Item

Large Floorplates



Stunning Receptions



Hotel-style Service



Branding Opportunities



Maintained Kitchens



Great Bathrooms



Toiletries



Attention to Detail





THE STONEMARTIN
MISSION STATEMENT

DELIVERING
FLEXIBLE BESPOKE
WORKSPACE AND
CONFERENCE
FACILITIES

WITH TOP QUALITY
SERVICE TO THE
BENEFIT OF OUR
CUSTOMERS'
BUSINESS



To find out more about Stonemartin buildings across the UK visit
www.stonemartin.com

For national enquiries about any of our services or office requirements call 0845 070 9970

NBSH

NEW
BROAD STREET
HOUSE

CITY OF LONDON

New Broad Street House, 35 New Broad Street, London, EC2M 1NH



New Broad Street House, our stunning flagship building in the heart of the City's financial district, offers the perfect business location surrounded by bar, restaurant and retail facilities. Traditional on the outside, cutting edge on the inside, New Broad Street House offers an enticing mix of elegance and opulence. The building affords a professional, corporate environment that provides comfort as standard – from its classic façade and the contemporary styling of the reception area through to the stunning atrium that houses our first class IoD hub conferencing venue.



IoD Directors' Room



IoD hub Conferencing

- An environment that allows your business to grow in line with your plan in a cost effective manner
- The ability to focus your time on running your business not your property
- The benefit of being part of a buzzing business environment
- Transfer of risk allowing greater visibility of associated costs
- Superior buildings in prime City Centre locations

GRADE 'A' PRIME OFFICE SPACE RIGHT IN THE HEART OF THE CITY

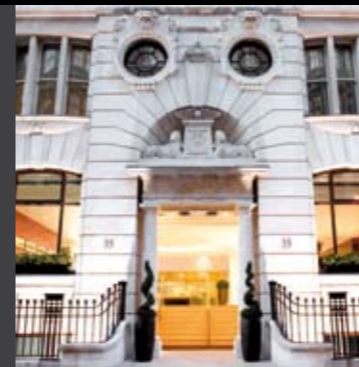

TYPICAL FLOORPLAN

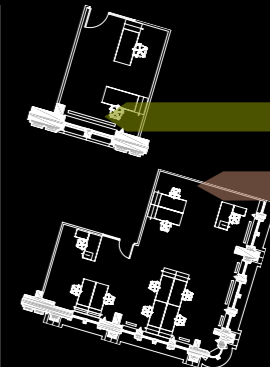
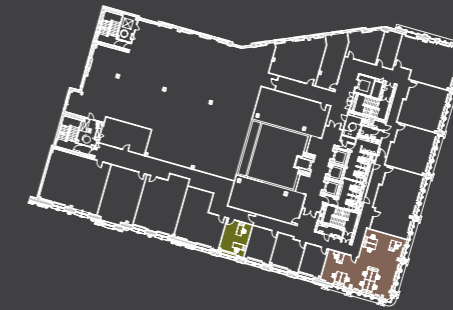

TYPICAL DENSITY

Offices typically provide a density of 1:75 sqft per person.

◦ 1-2 PERSON OFFICE

◦ 10 PERSON OFFICE

A workstation includes:
1600 mm cherry veneer laminate desk with integrated cable management system, bureau with two linear meters of storage (extending effective width of desk to 2000mm), Avaya VOIP telephone, ergonomic chair.

New Broad Street House is centrally located in the heart of the City of London, adjacent to the internationally renowned Broadgate complex and Liverpool Street railway station. New Broad Street House offers exclusive space in which to conduct your business. Space for you to communicate, to negotiate and to impress. All our rooms are unbranded so that you can tailor your space to create a true reflection of your company. And you can lease just as much floor space as you need. We understand that every business expands and contracts with its staffing levels. To meet these requirements for flexibility, we always aim to have available space for our clients to grow, where possible on a contiguous basis.

◦ AMENITIES

- Air conditioning
- Raised floor
- Cat 6 cabling
- DDA compliant
- Phone / call handling / messaging service / Smart numbers
- LAN cable infrastructure
- Client signage in reception
- Branding opportunities
- Secure and fully managed I.T.*
- High speed internet access*
- Secure firewall
- On-site I.T. support / helpdesk*
- On-site operational support / helpdesk
- Access to VLAN / Comms room and Peripheral network (printers etc.)
- Business support services*
- Kitchen / break-out - free coffee, tea and water
- CCTV
- Concierge
- Showers
- Private phone cubicles*
- Office desk and storage
- Cleaning
- 24 hour security and access

◦ OFFICES

- 105,000 sqft allows businesses to grow from a fully serviced office to a bespoke managed solution
- Floor plates up to 17,400 sqft
- Offices to accommodate company requirements up to 200 people
- Ability to accommodate offices from one person upwards
- Fully furnished and well equipped
- Space² virtual offices

◦ IoD hub CONFERRING*

- Total conferencing area of 8,905 sqft
- Meeting rooms to accommodate up to 100 people
- Training rooms to accommodate up to 160 people
- Event venue able to cater for up to 250 people
- Video conferencing and WiFi available
- ISDN and broadband provided
- Free local and national telephone calls
- Delegate business support available
- Free coffee, tea and water

◦ IoD DIRECTORS' ROOM*

- Free newspapers
- Free coffee, tea and water
- WiFi available
- Able to accommodate up to 50 members

Download a map at
www.stonemartin.com/city



For more information please visit www.stonemartin.com/city

To book a viewing please call 0845 070 9970

* Item may be subject to further charge



CALCULATE THE UNCONVENTIONAL

Find out how much you could save compared against the conventional product at

www.stonemartin.com/costcalc

We are proud
to be part of



Workplace
Performance
Initiative

www.workplaceperformance.net

For national enquiries about where your business could live throughout the UK call 0845 070 9970 or visit www.stonemartin.com